

GARDEN LOUNGE



U G / F

Garden Lounge

With floor-to-ceiling windows overlooking the picturesque St John's Cathedral, and more than a hint of sophistication, the elegant Garden Lounge on the Upper Ground level serves signature afternoon teas alongside a refreshing all-day menu featuring familiar Western and Asian signatures and an evening of seafood indulgence. The lounge exudes contemporary aesthetics of cool grey and gold accents and offers outdoor seating by the lush lawn, available for those who prefer a relaxed setting or who are visiting with pets.

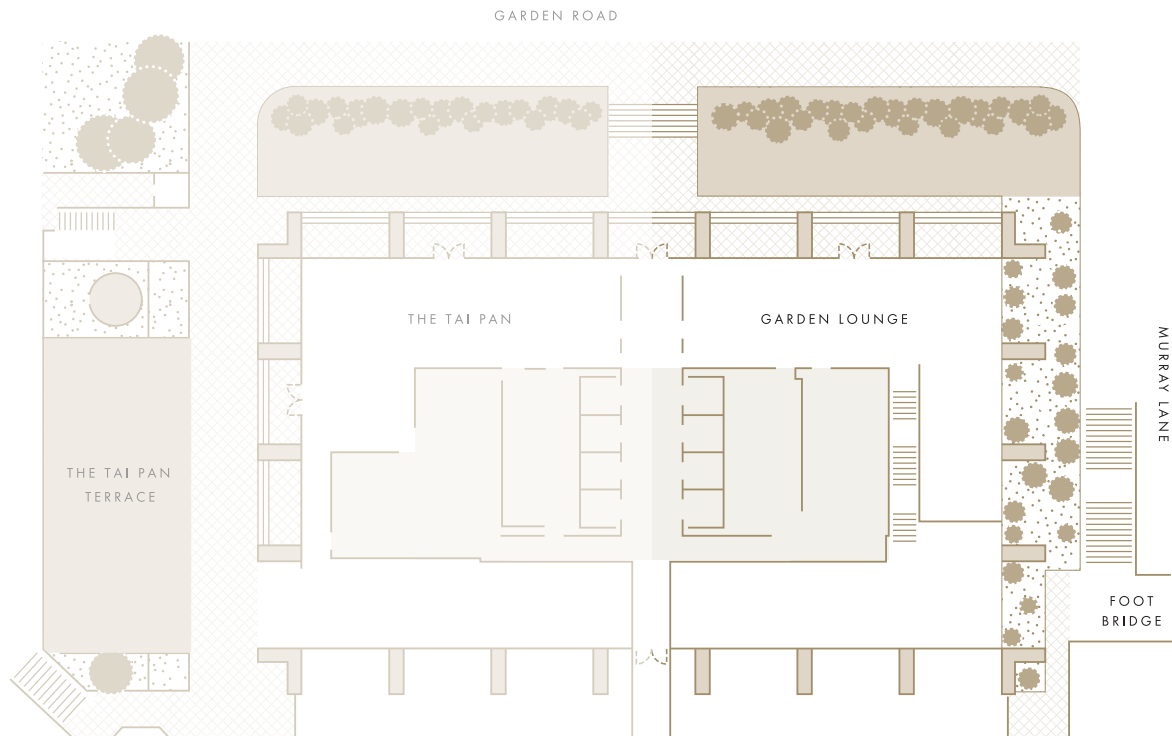

THE MURRAY

HONG KONG
—
A NICCOLO HOTEL

Venue	Area		Headroom		Set Up	
	Sqm	Sqf	H(m)	H(f)	Cocktail	Long Table
GARDEN LOUNGE	255	2,735	3.3	10.8	126	84
INDOOR	175	1,875	-	-	90	60
OUTDOOR	80	860	-	-	36	24

Capacities are indicative and subject to regulation approval.